



CLOCKWORK
COMPONENTS

AL7566

Dimensions: H150 x W110

Angled metal leg, available in:

Polished
AL7566P
Screw holes

Brushed
AL7566B
Screw holes

110mm

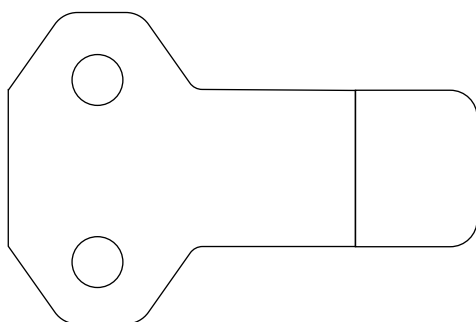

150mm

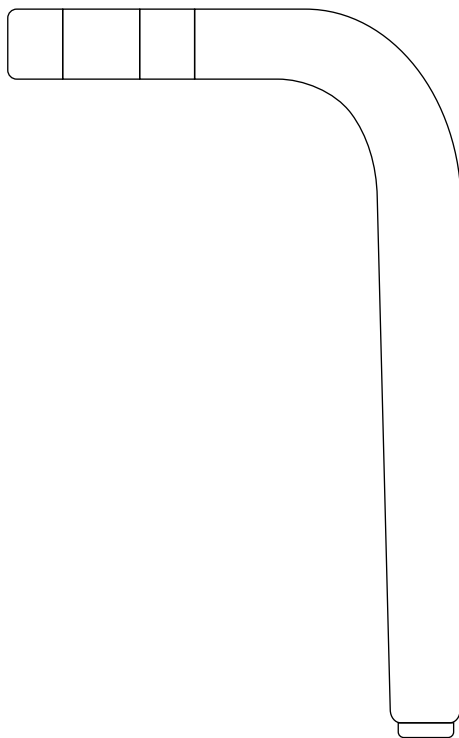

CLOCKWORK
COMPONENTS

CLOCKWORK COMPONENTS LTD.

T : 01993 775 767 F : 01993 892 313 E: sales@clockworkcomponents.com
www.clockworkcomponents.com

Aug 2023

All images, photos, text and designs are protected by copyright and may be subject to additional Design Right Protection